

**DESCRIPTIVE AND HISTORICAL
CATALOGUE OF THE PICTURES IN THE
NATIONAL GALLERY:
WITH BIOGRAPHICAL NOTICES OF THE
DECEASED PAINTERS. BRITISH AND
MODERN SCHOOLS**

Published @ 2017 Trieste Publishing Pty Ltd

ISBN 9780649561148

Descriptive and Historical Catalogue of the Pictures in the National Gallery: With Biographical Notices of the Deceased Painters. British and Modern Schools by The National Gallery British School

Except for use in any review, the reproduction or utilisation of this work in whole or in part in any form by any electronic, mechanical or other means, now known or hereafter invented, including xerography, photocopying and recording, or in any information storage or retrieval system, is forbidden without the permission of the publisher, Trieste Publishing Pty Ltd, PO Box 1576 Collingwood, Victoria 3066 Australia.

All rights reserved.

Edited by Trieste Publishing Pty Ltd.
Cover @ 2017

This book is sold subject to the condition that it shall not, by way of trade or otherwise, be lent, re-sold, hired out, or otherwise circulated without the publisher's prior consent in any form or binding or cover other than that in which it is published and without a similar condition including this condition being imposed on the subsequent purchaser.

www.triestepublishing.com

THE NATIONAL GALLERY BRITISH SCHOOL

**DESCRIPTIVE AND HISTORICAL
CATALOGUE OF THE PICTURES IN THE
NATIONAL GALLERY:
WITH BIOGRAPHICAL NOTICES OF THE
DECEASED PAINTERS.
BRITISH AND MODERN SCHOOLS**

To William Howe Daines,
from his sincere friend,
Sidney Dickinson,
DESCRIPTIVE AND HISTORICAL *London,*

CATALOGUE

OF THE

PICTURES

IN

THE NATIONAL GALLERY:

WITH

Biographical Notices of the Deceased Painters.

BRITISH AND MODERN SCHOOLS.

By Authority.



FORTY-EIGHTH EDITION.

LONDON:

PRINTED FOR HER MAJESTY'S STATIONERY OFFICE,
AND SOLD AT THE GALLERY.

1885.

Price Sixpence.

PLAN OF THE GALLERY FLOOR.

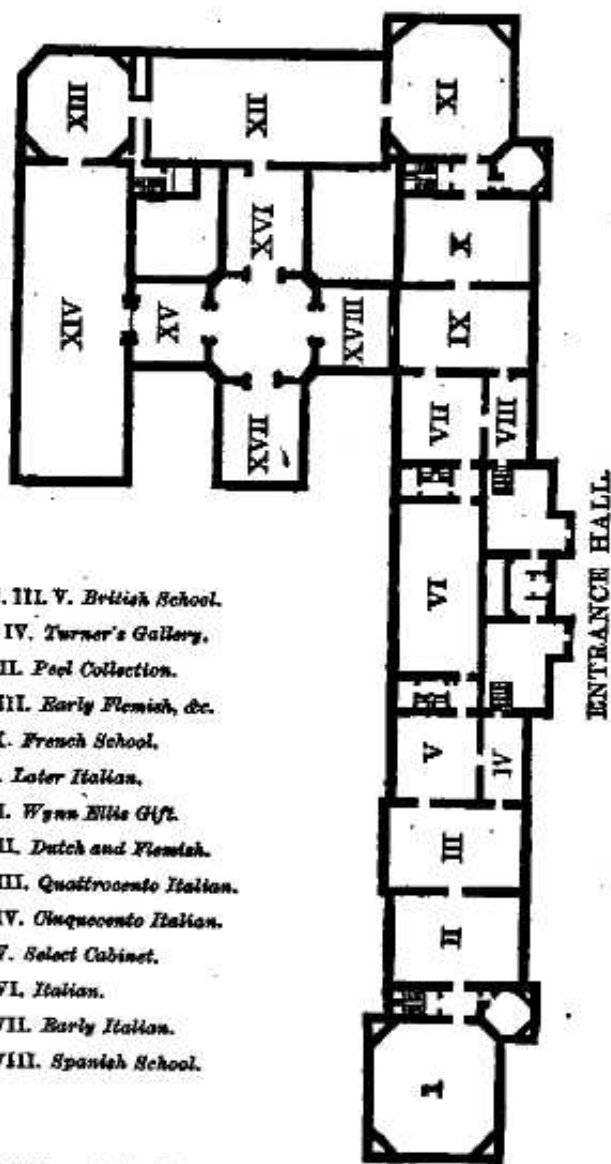

- II, III, V. *British School.*
 I, IV. *Turner's Gallery.*
 VII. *Peel Collection.*
 VIII. *Early Flemish, &c.*
 IX. *French School.*
 X. *Later Italian.*
 XI. *Wynn Ellis Gift.*
 XII. *Dutch and Flemish.*
 XIII. *Quattrocento Italian.*
 XIV. *Seicento Italian.*
 XV. *Select Cabinet.*
 XVI. *Italian.*
 XVII. *Early Italian.*
 XVIII. *Spanish School.*

NOTICE.

In using this Catalogue in the Gallery, reference should be made from the painter's name on the frame of the picture to the corresponding name at the head of the page in the catalogue, where the order is alphabetical. Should the name of the master on the picture frame from any cause not be easily legible, it may be found by referring to the number in the Index list, page 6, corresponding with the number of the picture.

The National Gallery is open to the public *free* on Mondays, Tuesdays, Wednesdays, and Saturdays throughout the year during the following hours:—

January	From 10 A.M. until 4 P.M.
February	} From 10 A.M. until 5 P.M.
March	
April	
May	} From 10 A.M. until 6 P.M.
June	
July	
August	
September	} From 10 A.M. until dusk.
October	
November	
December	

The Gallery is open to Students on Thursdays and Fridays during the above-mentioned months from 10 A.M. to 5 P.M. in summer, and 4 P.M. in winter, and to the Public on the same days from 11 o'clock A.M. on *payment of sixpence*.

THE

NATIONAL GALLERY, BRITISH SCHOOL.

THE National Gallery of Pictures was founded in 1824, during the administration of the Earl of Liverpool, by the purchase of the collection of John Julius Angerstein, Esq., consisting of thirty-eight pictures, comprising nine specimens of the British school. This collection, which thus formed the nucleus of the present National Gallery, was secured to the nation by a grant of Parliament, voted April the 2nd, 1824; and it was opened to the public in the house of Mr. Angerstein in Pall Mall, on May the 10th of that year.

In 1826 the collection was increased by the liberal donation of sixteen pictures from Sir George Beaumont, including five works of the British School; and in 1831 it was enriched by the valuable bequest of the Rev. William Holwell Carr, comprising, however, only one English picture.

Up to the year 1847, nearly a quarter of a century after its foundation, the National Gallery contained only forty-one pictures of the British School; but on December the 22nd of that year it was greatly increased by the munificent donation of Robert Vernon, Esq., who presented by deed of gift to the Trustees of the National Gallery, a collection of one hundred and fifty-seven pictures, all, with only two exceptions, by painters of the British School. And on the 25th of September 1856, the national collection was further largely increased by the acquisition, in pursuance of an order of the Court of Chancery, of the great bequest of Joseph Mallord William Turner, R.A., consisting of about one hundred finished oil pictures, and some thousand drawings and sketches in water-colours, &c.

The National Gallery British School contains about three hundred pictures, by seventy masters of British birth or descent, for the most part presented or bequeathed to the Trustees. Complete lists of the donations and bequests, and of the Turner drawings and sketches permanently exhibited to the public, will be found at the end of the Catalogue.

INDEX

TO THE

NAMES OF THE MASTERS OF THE PICTURES IN THE NATIONAL GALLERY—BRITISH SCHOOL.

ARRANGED ACCORDING TO THE NUMBERS OF THE PICTURES.

<p>No. 78 } Reynolds, <i>Sir Joshua</i> 79 } 80 Gainsborough, <i>Thomas</i> 99 Wilkie, <i>Sir David</i> 100 Copley, <i>John S.</i> 105 Beaumont, <i>Sir George</i> 106 } Reynolds, <i>Sir Joshua</i> 107 } 106 Wilson, <i>Richard</i> 109 Gainsborough, <i>Thomas</i> 110 Wilson, <i>Richard</i> 111 Reynolds, <i>Sir Joshua</i> 112 } 113 } 114 } Hogarth, <i>William</i> 115 } 116 } 117 } 118 } 119 Beaumont, <i>Sir George</i> 120 Beechey, <i>Sir William</i> 121 West, <i>Benjamin</i> 122 Wilkie, <i>Sir David</i> 123 Williams, <i>Edward</i> 124 Jackson, <i>John</i> 126 West, <i>Benjamin</i> 128 Reynolds, <i>Sir Joshua</i> 129 Lawrence, <i>Sir Thomas</i> 130 Constable, <i>John</i> 131 } West, <i>Benjamin</i> 132 } 133 Hoppner, <i>John</i> 136 Lawrence, <i>Sir Thomas</i> 139 Kaufmann, <i>Angelica</i></p>	<p>No. 142 Lawrence, <i>Sir Thomas</i> 143 Reynolds, <i>Sir Joshua</i> 144 Lawrence, <i>Sir Thomas</i> 162 Reynolds, <i>Sir Joshua</i> 171 Jackson, <i>John</i> 178 Hilton, <i>William</i> 182 Reynolds, <i>Sir Joshua</i> 183 Phillips, <i>Thomas</i> 185 Reynolds, <i>Sir Joshua</i> 188 Lawrence, <i>Sir Thomas</i> 217 } 220 } Stuart, <i>Gilbert</i> 229 } 231 Wilkie, <i>Sir David</i> 233 Hoppner, <i>John</i> 241 Wilkie, <i>Sir David</i> 267 Wilson, <i>Richard</i> 273 Kneller, <i>Sir Godfrey</i> 301 } 302 } Wilson, <i>Richard</i> 303 } 304 } 305 } 306 } Reynolds, <i>Sir Joshua</i> 307 } 308 } 309 } Gainsborough, <i>Thomas</i> 310 } 311 } 312 Romney, <i>George</i> 313 } Scott, <i>Samuel</i> 314 } 315 West, <i>Benjamin</i> 316 Louthembourg, <i>Phillip J.</i></p>
---	--

INDEX TO NAMES OF MASTERS.

7

No.	
317	} Stothard, <i>Thomas</i>
318	
319	
320	
321	
322	
323	Bird, <i>Edward</i>
324	} Lawrence, <i>Sir Thomas</i>
325	
326	
326	Jackson, <i>John</i>
327	Constable, <i>John</i>
328	} Wilkie, <i>Sir David</i>
329	
330	
331	
332	
333	} Hilton, <i>William</i>
334	
335	
336	
337	
338	} Phillips, <i>Thomas</i>
339	
340	
341	} Callcott, <i>Sir Augustus W.</i>
342	
343	
344	
345	
346	
347	
348	
349	Howard, <i>Henry</i>
350	Thomson, <i>Henry</i>
351	} Collins, <i>William</i>
352	
353	} Newton, <i>Gilbert S.</i>
354	
355	Geddes, <i>Andrew</i>
356	} Etty, <i>William</i>
357	
358	
359	
360	
361	
362	
363	
364	

No.	
365	} Etty, <i>William</i>
366	
367	} Shee, <i>Sir Martin A.</i>
368	
369	} Turner, <i>Joseph M. W.</i>
370	
371	
372	} Allan, <i>Sir William</i>
373	
374	Bonington, <i>Richard P.</i>
375	} Briggs, <i>Henry P.</i>
376	
377	Clint, <i>George</i>
378	Good, <i>Thomas S.</i>
379	Müller, <i>William J.</i>
380	} Nasmyth, <i>Patrick</i>
381	
382	Simpson, <i>John</i>
383	} Wyatt, <i>Henry</i>
384	
385	} Ward, <i>James</i>
386	
387	} Uwins, <i>Thomas</i>
388	
389	} Jones, <i>George</i>
390	
391	
392	} Mulready, <i>William</i>
393	
394	
395	
396	
397	} Eastlake, <i>Sir Charles L.</i>
398	
399	
400	Roberts, <i>David</i>
401	} Leslie, <i>Charles R.</i>
402	
403	
404	} Stanfield, <i>Clarkson</i>
405	
406	
407	} Landseer, <i>Charles</i>
408	
409	} Landseer, <i>Sir Edwin</i>
410	
411	
412	

No.		No.	
413	} Landsver, <i>Sir Edwin</i>	461	} Turner, <i>Joseph M. W.</i>
414		462	
415	} Pickersgill, <i>Henry W.</i>	463	
416		464	
417		465	
418	} Lee, <i>Frederick R.</i>	466	
419		467	
420	} Witherington, <i>William F.</i>	468	
421		469	
422	} MacIise, <i>Demiel</i>	470	
423		471	
424	Hart, <i>Solomon A.</i>	472	
425	Herbert, <i>John R.</i>	473	
426	} Webster, <i>Thomas</i>	474	
427		475	
428	Redgrave, <i>Richard</i>	476	
429	Creswick, <i>Thomas</i>	477	
430	} Ward, <i>Edward M.</i>	478	
431		479	
432	} Williams, <i>Perry</i>	480	
433		481	
434	} Cooper, <i>Thomas S.</i>	482	
435		483	
436	Danby, <i>Francis</i>	484	
437	} Linnell, <i>John</i>	485	
438		486	
439	Lane, <i>Theodore</i>	487	
440	} Lance, <i>George</i>	488	
441		489	
442	} Egg, <i>Augustus L.</i>	490	
443		491	
444	Pickersgill, <i>Frederick R.</i>	492	
445	Horsley, <i>John C.</i>	493	
446	} Cooke, <i>Edward W.</i>	494	
447		495	
448	Johnston, <i>Alexander</i>	496	
449	} Goddall, <i>Frederick</i>	497	
450		498	
451	Herring, <i>John F.</i>	499	
452	Fraser, <i>Alexander</i>	500	
453	} Rippingille, <i>Edward V.</i>	501	
454		502	
455	Haghe, <i>Louis</i>	503	
456	Dubufe, <i>Claude M.</i>	504	
457	} Turner, <i>Joseph M. W.</i>	505	
458		506	
459		507	
460		508	