

**EXHIBITION OF WORKS BY THE
OLD MASTERS, AND BY DECEASED
MASTERS OF THE BRITISH SCHOOL;
WINTER EXHIBITION, EIGHTEENTH
YEAR MDCCCLXXXVII**

Published @ 2017 Trieste Publishing Pty Ltd

ISBN 9780649333004

Exhibition of Works by the Old Masters, and by Deceased Masters of the British School; Winter exhibition, eighteenth year MDCCCLXXXVII by Various

Except for use in any review, the reproduction or utilisation of this work in whole or in part in any form by any electronic, mechanical or other means, now known or hereafter invented, including xerography, photocopying and recording, or in any information storage or retrieval system, is forbidden without the permission of the publisher, Trieste Publishing Pty Ltd, PO Box 1576 Collingwood, Victoria 3066 Australia.

All rights reserved.

Edited by Trieste Publishing Pty Ltd.
Cover @ 2017

This book is sold subject to the condition that it shall not, by way of trade or otherwise, be lent, re-sold, hired out, or otherwise circulated without the publisher's prior consent in any form or binding or cover other than that in which it is published and without a similar condition including this condition being imposed on the subsequent purchaser.

www.triestepublishing.com

VARIOUS

**EXHIBITION OF WORKS BY THE
OLD MASTERS, AND BY DECEASED
MASTERS OF THE BRITISH SCHOOL;
WINTER EXHIBITION, EIGHTEENTH
YEAR MDCCCLXXXVII**

EXHIBITION

OF WORKS BY

THE OLD MASTERS,

AND BY

Deceased Masters of the British School;

INCLUDING

A COLLECTION OF WATER-COLOUR DRAWINGS

BY

JOSEPH M. W. TURNER, R.A.



WINTER EXHIBITION,

EIGHTEENTH YEAR.

MDCCCLXXXVII.

LONDON:

PRINTED BY WM. CLOWES AND SONS, LIMITED, 14, CHARING CROSS,

PRINTERS TO THE ROYAL ACADEMY.

The Exhibition opens the first Monday in January, and closes the second Saturday in March.

Hours of Admission from 9 A.M. till dusk.

Price of Admission, 1s.

Price of Catalogue: Large, with paper cover, 6d.; Small, bound in cloth, with pencil, 1s.

Season Ticket, 5s.

General Index to the Catalogues of the first ten Exhibitions, 1870-79, 1s. 6d.

The Refreshment Room is reached by the staircase leading out of the Water-Colour Room.

The Gibson (Sculpture) Gallery and the Diploma Galleries are open daily, from 11 A.M. to 4 P.M. Admission free.

All communications should be addressed to "The Secretary."

GIFT

LOAN STACK

ROYAL ACADEMY OF ARTS, 1887.

N5054
A28
1887

HONORARY MEMBERS.

THE ARCHBISHOP OF YORK, *Chaplain.*
 RT. HON. W. E. GLADSTONE, M.P., *Professor of Ancient History.*
 THE DEAN OF CHRIST CHURCH, *Professor of Ancient Literature.*
 C. T. NEWTON, ESQ., C.B., *Antiquary.*
 ROBERT BROWNING, ESQ., *Secretary for Foreign Correspondence.*

HONORARY RETIRED ACADEMICIANS.

COPE, CHARLES WEST, ESQ. | HERBERT, JOHN ROGERS, ESQ.
 COUSINS, SAMUEL, ESQ. | BEDGRAVE, RICHARD, ESQ., C.B.

HONORARY FOREIGN ACADEMICIANS.

GALLAIT, LOUIS. | HENRIQUEL-DUPONT, LOUIS PIERRE.
 GÉRÔME, JEAN LÉON. | KNAUS, LUDWIG.
 GUILLAUME, CLAUDE JEAN BAPTISTE EUG. | MEISSONIER, JEAN LOUIS.

ACADEMICIANS.

ALMA-TADEMA, LAWRENCE, ESQ.	LEIGHTON, SIR FREDERICK, BART., <i>President and Trustee.</i>
ARMITAGE, EDWARD, ESQ.	MARKS, HENRY STACY, ESQ.
ARMSTEAD, HENRY HUGH, ESQ.	MARSHALL, WILLIAM CALDER, ESQ.
BARLOW, THOS. OLDHAM, ESQ.	MILLAR, SIR JOHN EVERETT, BART., <i>Trustee</i>
BOHEM, JOSEPH EDGAR, ESQ.	ORCHARDSON, WILLIAM QUILLER, ESQ.
CALDERON, PHILIP H., ESQ.	OCLES, WALTER WILLIAM, ESQ., <i>Auditor.</i>
COLE, VICAT, ESQ.	PEARSON, JOHN LOGGHOBOURGH, ESQ.
COOPER, THOMAS SIDNEY, ESQ.	PETTIE, JOHN, ESQ.
DAVIS, HENRY WM. BANKS, ESQ.	PICKERSGILL, FREDK. RICH., ESQ., <i>Keeper and Trustee.</i>
DOBSON, WM. CHAS. THOS., ESQ.	POYNTER, EDWARD J., ESQ.
FARD, THOMAS, ESQ.	RICHMOND, GEORGE, ESQ.
FRITH, WILLIAM POWELL, ESQ.	RIVERS, BRITON, ESQ., <i>Auditor.</i>
GILBERT, SIR JOHN.	SANT, JAMES, ESQ.
GOODALL, FREDERICK, ESQ.	SHAW, RICHARD NORMAN, ESQ.
GRAHAM, PETER, ESQ.	STOCKS, LUIR, ESQ.
HODGSON, JOHN EVAN, ESQ., <i>Librarian.</i>	WATERHOUSE, ALFRED, ESQ.
HOLL, FRANK, ESQ.	WATTS, GEORGE FREDERICK, ESQ.
HOOK, JAMES CLARK, ESQ.	WELLS, HENRY TANWORTH, ESQ., <i>Auditor</i>
HOBSELY, JOHN CALCOTT, ESQ., <i>Treasurer and Trustee.</i>	WOOLNER, THOMAS, ESQ.
LESLIE, GEORGE DONLOP, ESQ.	YEAMES, WILLIAM FREDERICK, ESQ.
LONG, EDWIN, ESQ.	

HONORARY RETIRED ASSOCIATES.

LE JEUNE, HENRY. | NICOL, ESSKINE.
 WOODINGTON, WILLIAM FREDERICK.

ASSOCIATES.

AITCHISON, GEORGE.	FILDES, LUKE.	MORRIS, PHILIP RICHARD.
BIBCH, CHAS. B.	GILBERT, ALFRED.	OAKES, JOHN WRIGHT.
BODLEY, GEORGE FREDERICK.	GOW, ANDREW.	PRINSEP, VAL. CAMERON.
BOUGHTON, GEORGE H.	GREGORY, EDWARD JOHN.	STACPOOLE, FREDERICK.
BRETT, JOHN.	HERKOMER, HUBERT.	STONE, MARCUS, R.A. <i>Elect.</i>
BROCK, THOMAS.	HUNTER, COLIN.	STOREY, GEORGE ADOLPHUS.
BURGESS, JOHN BAGNOLD.	LEADER, BENJ. WILLIAMS.	THORNYCROFT, HARG.
BURNE-JONES, EDWARD.	LUCAS, JOHN SHYMOUR.	WATERHOUSE, J. WILLIAM.
CROFTS, EBERT.	MACBETH, ROBERT WALKER.	WOODS, HENRY.
CROWE, EYRE.	MCWHIRTER, JOHN.	
DICKSEE, FRANK.	MOORE, HENRY.	

PROFESSORS.

Of *Painting*, J. E. HODGSON, ESQ., R.A. | Of *Architecture*,
 Of *Sculpture*, | Of *Anatomy*, JOHN MARSHALL, ESQ., F.R.S.
 Of *Chemistry*, ARTHUR H. CHURCH, ESQ., M.A.
 Teacher of *Perspective*, HENRY ALEXANDER BOWLER
 Master in the Class of *Architecture*, RICHARD PHENÉ SPIERS.

SECRETARY—FRED. A. EATON

CONTENTS.

Oil Paintings—	PAGE
GALLERY I.	5
" II.	14
" III.	26
" IV.	38
Water Colours—	
BLACK AND WHITE ROOM—(J. M. W. TURNER, R.A.) ..	48
WATER-COLOUR ROOM— ditto ..	55
INDEXES	65

PLAN OF THE GALLERIES.

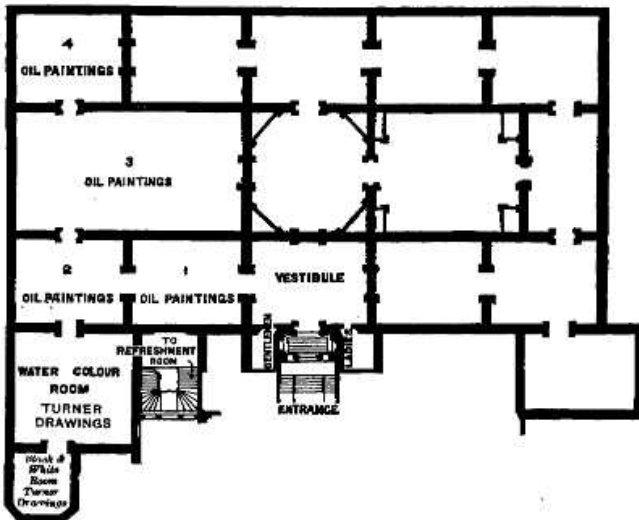

CATALOGUE.

The Numbers follow from left to right, the first Number being next the door.

The Portraits are described under four sizes:—"bust," the head and shoulders; "half figure," to the waist; "three-quarter figure," to the knee and below; "full length," the entire figure.

The terms "to right," "to left," and "on right," "on left," in all descriptions, denote the right and left of the spectator.

The following abbreviations are used:—b. born, m. married, d. died, r. right, l. left.

In the sizes of the Works the height is always placed before the width.

The Works are Catalogued under the names given to them by the Contributors. The Academy can accept no responsibility as to their authenticity.

GALLERY No. I.

OIL PAINTINGS—1-48.

LENT BY	PAINTER.
1	LANDSCAPE.
R. H. BENSON, Esq.	Thomas Gainsborough, R.A.

View over a wooded valley; on a slope in the foreground are two figures, one holding a child; on the l. is seen a man driving a horse along a road which leads through a wood; hills on each side of the valley; blue sky, with clouds. Canvas, 15½ by 20½ in.

2	CLASSICAL LANDSCAPE.
JAMES OSBROCK, Esq.	Richard Wilson, R.A.

Distant view of a town seen across a river, which winds through the centre of the landscape between wooded and rocky heights; group of figures and large tree in l. foreground; blue sky, with clouds. Canvas, 19 by 22 in.

- | LENT BY | PAINTER. |
|---------------------------------------------------------------------------------------------------------------------------------------------------------------------------------------------------------------------------------------------------------------------------------------------------------------------------------------------------------------------------|-------------------------------------|
| 3 | LANDSCAPE, with Men Bathing. |
| CHARLES T. D. CREWS, Esq. | John J. Chalon, R.A. |
| <p>In the l. foreground is a river bordered with high banks and lofty trees; several figures of men bathing; one in the immediate foreground in the act of dressing; behind him another, seated on the trunk of a fallen tree; beyond is a wide meadow, in which harvesting operations are going on; line of hills in the distance; sunset sky. Canvas, 41½ by 36 in.</p> | |
| 4 | Portraits of TWO CHILDREN. |
| Mrs HENRY THOMPSON. | Samuel Medley. |
| <p>Two full-length figures of little girls, in white dresses, with fair hair, seated on a bank, under some trees. Canvas, 27 by 35 in.
Exhibited at the Royal Academy, 1797 (No. 505).</p> | |
| 5 | LANDSCAPE. |
| Mrs. LANE. | Thomas Gainsborough, R.A. |
| <p>The edge of a wood; a figure going along a road which winds away into the distance; cloudy sky. Panel, 9 by 7 in.</p> | |
| 6 | LANDSCAPE. |
| Mrs. LANE. | Thomas Gainsborough, R.A. |
| <p>The outskirts of a wood; several figures seated in a hollow overshadowed by large trees; cloudy sky. Canvas, 9 by 7 in.</p> | |
| 7 | LAGO DI COMO. |
| EARL OF NORMANTON. | Richard Wilson, R.A. |
| <p>Lake in the middle distance; rocky and wooded height on the l. on which two men are prostrating themselves in front of a crucifix; man on horseback in the foreground descending towards the lake, and on the r. two women seated under an umbrella; hills in the distance; blue sky, with clouds. Canvas, 17½ by 23 in.</p> | |
| 8 | Portrait of THOMAS CHEESMAN. |
| T. HUMPHREY WARD, Esq. | Francis Bartolozzi, R.A. |
| <p>Engineer and draftsman; was a pupil of Bartolozzi's, and practised at the end of the last and beginning of the present century.
Small bust to l., profile; grey coat; powdered hair; dark background.
Canvas, 12½ by 10 in. (oval).</p> | |

- | LENT BY | PAINTER. |
|--------------------------------------------------------------------------------------------------------------------------------------------------------------------------------------------------------------------------------------------------------------------------------------------|-------------------------------------------------|
| 9 | Portrait of SIR WILLIAM BEECHY, B.A. |
| EARL OF NORMANTON. | George Henry Harlow. |
| Portrait painter; b. in Oxfordshire, 1753; student at the Royal Academy, 1772; A.R.A., 1793; R.A., 1798; knighted 1798; d. 1839. | |
| Small three-quarter figure, seated to l. in an arm-chair, resting his head on his r. hand; red fur-trimmed robe. In the background is seen a portion of Beechey's picture, at Hampton Court, of George III. and the Prince of Wales reviewing the 10th Light Dragoons. Panel, 21 by 16 in. | |
| 10 | COAST SCENE. |
| R. H. BENSON, Esq. | John Sell Cotman. |
| View at the mouth of a river, with the buildings of a town on the l. lit up by the rising sun; sea in the r. distance; in the foreground are fishing-boats aground drying their sails; other figures and boats; cloudy sky. Canvas, 52 by 88 in. | |
| 11 | Portraits of TWO CHILDREN. |
| LORD THURLOW. | George Romney. |
| Maria and Catherine, daughters of Edward, Lord Chancellor Thurlow. Maria m. 1801, Sir David Cunynghame, 5th Bart.; d. 1816. Catherine m. 1815, Alex. George, 16th Baron Saltoun; d. 1826. | |
| Two full-length figures in white dresses, standing at a harpsichord, looking at the spectator; one is playing the instrument, while the other leans on it; both girls wear large white caps trimmed with flowers and ribbons; brown background. Canvas, 60 by 47 in. | |
| 12 | Portrait of ANNE, DUCHESS OF GRAFTON. |
| EARL OF NORMANTON. | Sir Joshua Reynolds, P.R.A. |
| Daughter of the 1st Baron Ravensworth; m. 1st 1756, Augustus Henry, Earl of Euston, afterwards 3rd Duke of Grafton; was divorced from him in 1763; m. 2ndly, John Fitzpatrick, 2nd Earl of Upper Ossory; d. 1804. | |
| Half figure to r., three-quarter profile; black low-cut dress and fur-trimmed cloak; she holds up some flowers in her r. hand; landscape background. Painted about 1764. Canvas, 30 by 24½ in. | |
| 13 | Portrait of THE RIGHT HON. JOHN THURLOE. |
| LORD THURLOW. | William Dobson. |
| B. 1616 at Roding Abbey, Essex; son of the rector of the parish; held several important offices; was Secretary of State to Oliver Cromwell in 1653; M.P. for Ely 1656, and for Cambridge University 1658; d. 1668. | |
| Three-quarter figure seated to r. in a high-backed arm-chair, holding a letter addressed to himself in his r. hand; black velvet cloak, wide falling collar and cuffs, long hair; dark background. Canvas, 49 by 39½ in. | |